

Product: TASK DESK AND BENCH

Asterisco In is an integrated desks system, with different types of legs ("Portale" or "Cornice").

The two side legs are connected each other by metal beams that allow to interchange *Asterisco In* legs, creating a flexible system.

22 mm thick square tops are available in different finishes and dimensions.

The screen panel could be in fabric or glass with soundproof characteristics. Single and multiple desks as well as meeting tables are provided with electrification arrangement.

**TECHNICAL FEATURES**

Tops: tops are 22 mm thick (7/8") chipboard panels with anti-scratch and anti-reflect melamine surfaces; tops are edged in 2.5 mm thick PVC with radius on all edges. The tops are available in White Snow Laminate finish.

Return top: return top for task desk available in Melamine or White Snow laminate.

Legs: Arc welded metal structure powder coated in finish Titanium, Silver and UE White.

Available in the following versions:

- **Portale:** Portale legs have 5 (2") x 3 (1"1/8) cm section.
- **Cornice:** Cornice legs have 5 (2") x 3 (1"1/8) cm section.



Under-top structure: under-top beams have a section of 5 (2") x 3 (1"1/8) cm with an easy connection to the leg.

Bases structures: bases for task desks available in Melamine, with drawers or filing cabinet.

Modesty Panel (for single desk): available H30 or H60, in Melamine finish or covered with Time fabric.

Screen and side panels (for bench): Fabric covered, Fabric covered with an Aluminium frame or in Glass.



«Portale» legs



«Cornice» legs.

FINISHES

Tops:

Melamine: UE White, Silver, Titanio, Delavè, Comfort, White Snow, Magnolia, Oak 2017, Eucalyptus, White Colour Fir.

White Snow Laminate.

Return desk:

Melamine: see desk top finishes.

White Snow Laminate.

Legs: glossy UE White, glossy Silver, matt Titanio varnished metal.

Bases structures: Melamine, see desk top finishes.

Modesty Panel (for single desk):

Melamine: see desk top finishes.

Time 800, for task desk.

Time 791, for executive desk.

Screen and side panels (for bench):

Smart Office - Fabric cat. B, F, G, L.

Panel frame in varnished Aluminium, see legs finishes.

Back-lacquered etched glass: White, Silver, Titanio, Brown, Alfa Red.

DIMENSIONS

Single desk.

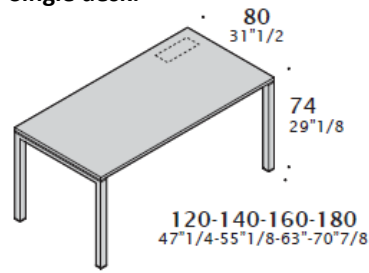

Options:

H74 and D80-100 available with all width options.

On W120 top, the top access is in the center.

2 seats bench.

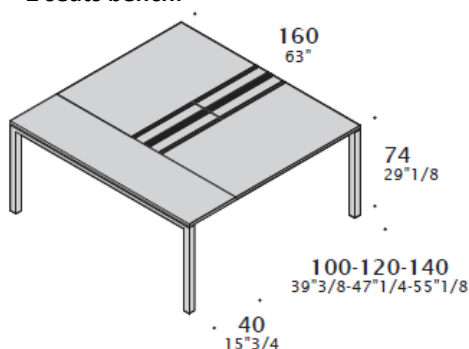

Options:

H74 and D160 available with all width options.

4 seats bench.

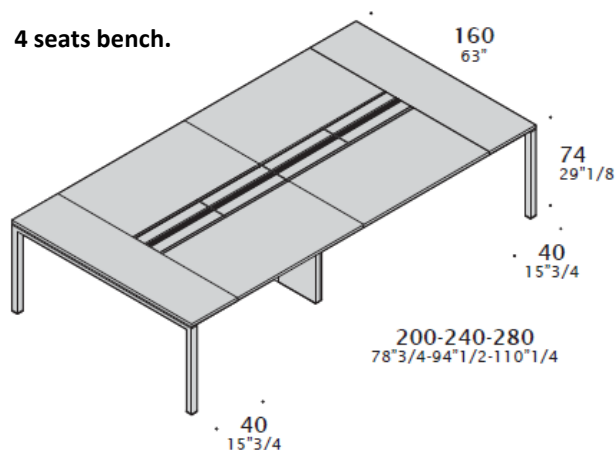

Options:

H74 and D160 available with all width options.

For 4 seats bench with full length equipped bar available only **280 (110 1/4) - 320 (126 1/2)** width options.

6 seats bench

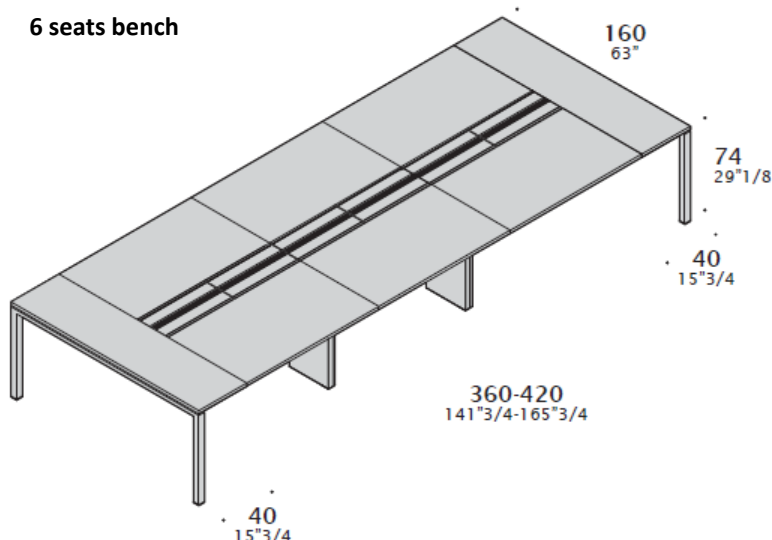

Bench equipped bar: also available full desk length; in the same finish as the structure.

Flips are in the same finish as the top.

Options:

H74 and D160 available with all width options.

For 6 seats bench with full length equipped bar available **360 (141 3/4) - 420 (165 3/8) - 480 (189 1/2)** width options.

ACCESSORIES

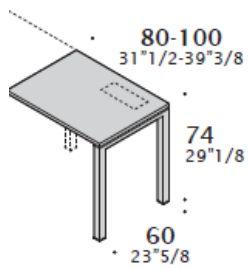

Return desk for single desk.

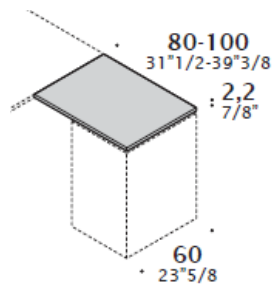

Return top.

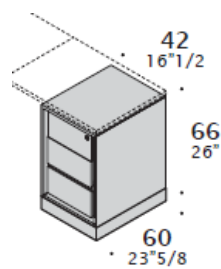

3 drawers base.

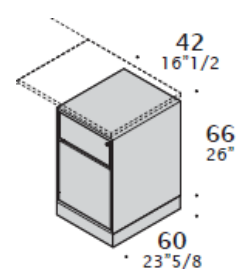

Filing cabinet base.

Modesty panels for single desk.

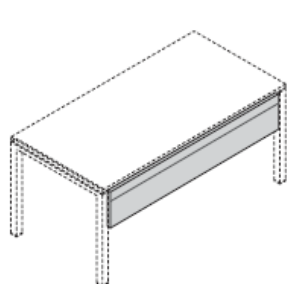

H30 (11"3/4).

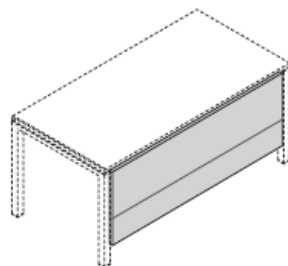

H60 (23"5/8).

Monitor holder in glossy Aluminium.

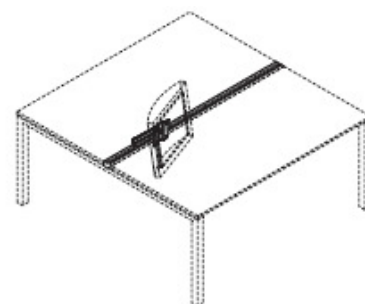

Side screen panels in fabric H36 (14"1/8).

The installation of side screen panels excludes the addition of frontal screen panels.

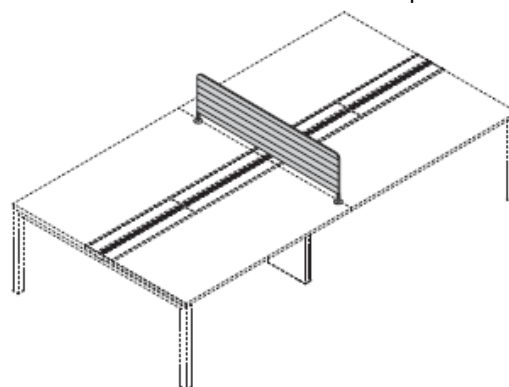
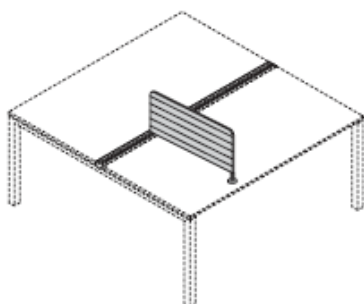

Frontal screen panel in fabric H36 (14"1/8).

Also available in Fabric with Aluminium frame and in glass.

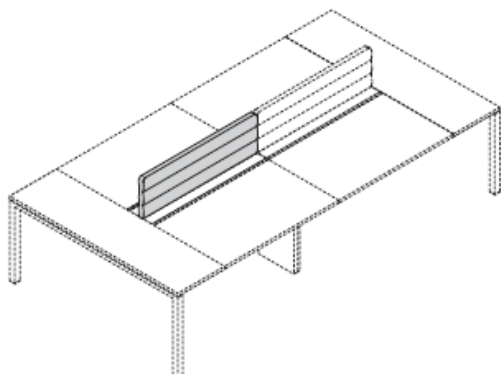

ELECTRIFICATION

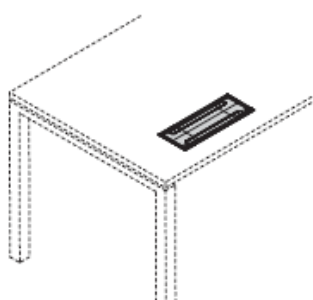

Top access for task desks: the flip can be opened in double sides. The top access is powder coated in White UE, Silver or Titanio finish, both in the frame which in the flip.

Top access are not included in the compositions. In the drawings, the dashed lines show the position of the top access.

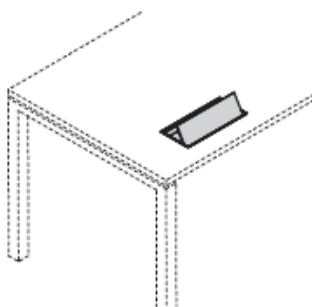

Optional top access.

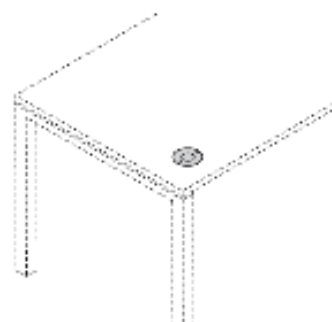

Cable outlet.

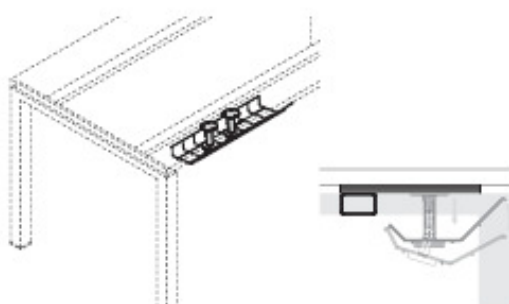

Cable tray fixed under the top that can be removed.
Metal net cable tray can lower and rotate for easy wiring.

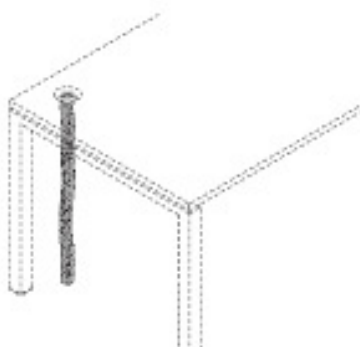

Cable management tube for single desk and for bench.

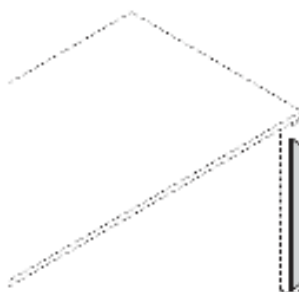

Clip-on cable management profile.

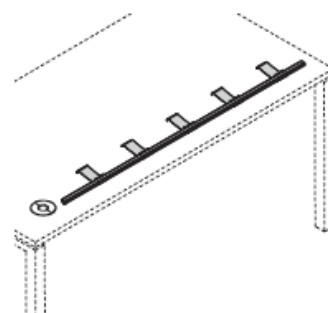

Horizontal vertebra.
Fixed under the top it allows to lead wiring from one side to the other of the top.

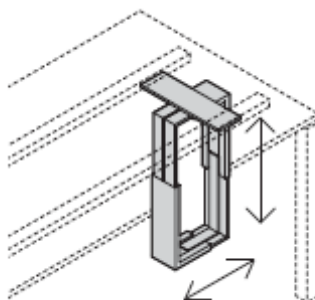
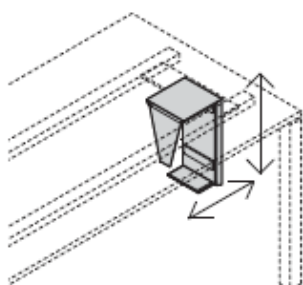

CPU holder with extensible support and extensible frame.

ELECTRIFICATION

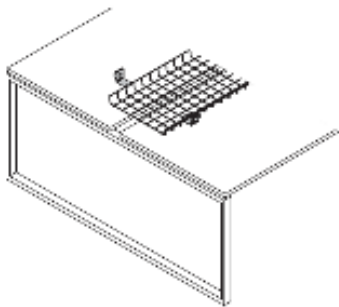

Removable shared cable for cable passage. Wooden flips fixed to the central equipped bar that allow easy cable passage.

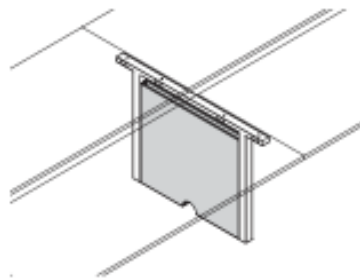

Cable metal management for intermediate leg, in the same finish of the legs.

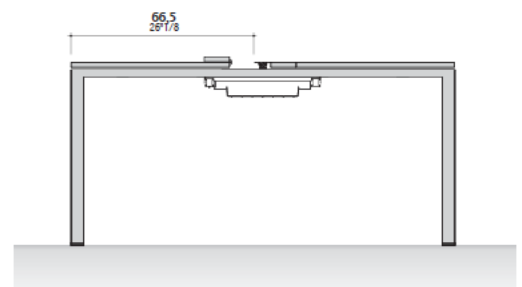

Equipped bar with full length and wooden flips. Wooden flips fixed to the central equipped bar allow easy cable passage.

Electrification examples.

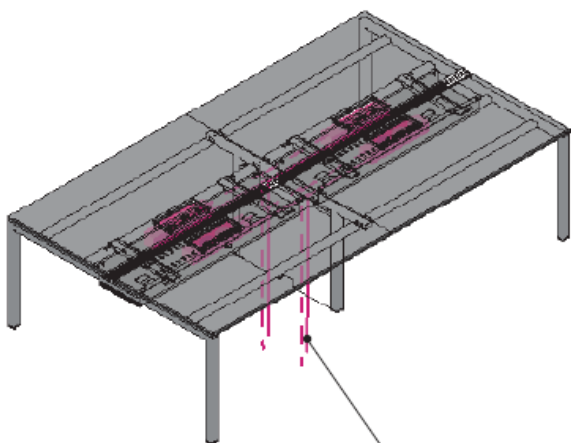

Intermediate leg cover for cable management.

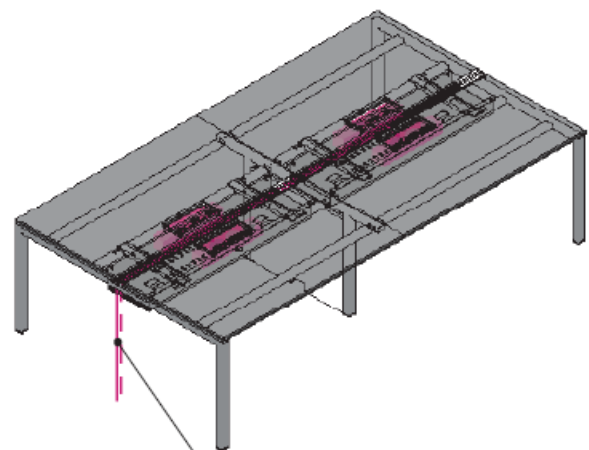

Cable management tube.

Cable management through the pedestal, top access and cable tray.

